

# BEVEL BALL ACTUATORS

To properly size actuators, follow the design tips found on page 161, and refer to the Column Load and Life Expectancy charts (pages 162 and 163). Use JAX® software to determine the dynamic capacity of actuators, or contact Joyce/Dayton.

Joyce high-efficiency bevel ball actuators (BB) are designed for near-continuous duty operation. BB series actuators provide higher speeds and less heat generation than other mechanical actuators and require a brake motor or other external locking device to hold position. They also offer more precise positioning and repeatability than hydraulic cylinders.

Bevel ball actuators are available in 7.5-ton to 100-ton static capacities and are able to attain travel speeds of up to 48 feet per minute. The ball screw and ball nut have a fully predictable J-10 life expectancy. Standard jacks have right hand ball screws. Left hand ball screws are available as an option. A threaded end condition is standard on translating bevel ball actuators; load pad and clevis ends are also available. KFTN designs have a plain turned end condition.

Bevel ball actuators are ideal for either single operation or multi-actuator systems. As many as three output shafts may be specified for mounting motors, limit switches, readout devices and other accessories. See page 195 for an example of a bevel gear jack system. Note that right hand and left hand screw threads are alternated in the layout.

Many options are available including oversized ball bearings, which can be specified to reduce endplay between ball screw and ball nut. All jack designs can be fitted with protective boots.

Joyce/Dayton can customize bevel ball actuators to meet your requirements.

Joyce/Dayton offers Bevel Ball Actuators in the following designs:

- Translating
- Keyed for traveling nut (KFTN)

A guide for ordering is on page 160.



# BEVEL BALL ACTUATORS ORDERING INFORMATION

**Instructions:** Select a model number from this chart.



Joyce Bevel Ball Actuators	
BB150	
BB225	
BB300	
BB400	





Evaluate column load (p. 162).  
 Evaluate ball nut life (p. 163).  
 Detailed product information (pp. 164-167).  
 Right hand ball screws standard.



Bevel Ball Actuator Rise
Rise is travel expressed in inches and not the actual screw length.

Screw Stops (p. 10) and Boots (p. 170)
Screw stops are optional on bevel ball actuators. When specified, the closed height of the jack and protection tube length may be increased.

Sample Part Number: **BB225U3S-12-XXXX-STDX-XXXX-B**

Actuator Configuration	
 U=Upright	 I=Inverted

End Conditions			
 1=T1 (plain end)	 2=T2 (load pad)	 3=T3 (threaded end)	 4=T4 (male clevis)

Actuator Design		
 S=Translating	 Keyed for Non Rotation is not a standard option	 N=Traveling Nut

Encoders and Electronic Limit Switches	
ENCX=Encoder (p. 178)	
ELS2=2 Position Electronic Switch (p. 174)	
ELS4=4 Position Electronic Switch (p. 174)	
ELS6=6 Position Electronic Switch (p. 174)	

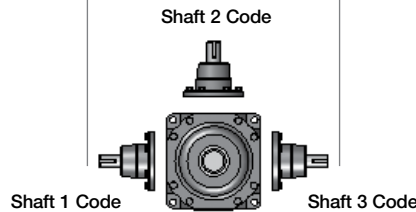









Shaft Codes
Three shaft codes must be specified for each jack. Electronic and mechanical limit switches may be substituted for the shaft code per the tables on this page.
STDX – Standard
XXXX – Input shaft not required
When ordering with only one input shaft, it is recommended to order the following configuration: XXXX-STDX-XXXX.

Additional Options
X=Standard Actuator, no additional options
S=Additional Specification Required (comment as necessary)
<b>Protective Boots</b> pp. 170-172
B=Protective Boot
D=Dual Protective Boot
<b>Finishes p. 179</b>
F1=Do not Paint
F2=Epoxy Paint
F3=Outdoor Paint Process
<b>Ball Screw</b>
L=Left Hand Screw
<b>Screw Stops</b> Extending stops standard
• Specify as many options as needed

## Mechanical Limit Switches (pp. 174-175)

Ordering Example: **LA13**

Models		Number of DPDT Switches (see p. 175)	Available Positions							
Model	Code		1	2	3	4	5	6	7	8
LS7-402	LI	NOTE: Will always be 0 for LS7 models								
LS8-402	LA									
LS8-404	LB									
LS9-502	LC									
LS9-503	LD									
LS9-504	LE									
LS9-505	LF									
LS9-506	LG									
LS9-507	LH									

Note: All BB actuators are available with all mounting positions.

# BEVEL BALL ACTUATORS SPECIFICATIONS AND DESIGN TIPS

Model	Dynamic Capacity	Static Capacity (Lbs)		Screw Dia./ Lead	Bevel Gear Ratio	Pinion Turns for 1" Travel	Pinion Torque (Raising)	Pinion Torque (Holding)	Screw Torque	Actuator Efficiency	Base Weight (Lbs)	Add for each inch of travel	
		Upright Assembly Screw in Tension	Upright Assembly Screw in Compression										
BB150	Please use JAX® V2 software or contact Joyce/Dayton	15,000	15,000	1.50/.25	2.69:1	10.77	.022W*	.018W*	.044W*	72.2%	52	0.7	
BB225		30,000	30,000	2.25/.50	2.15:1	4.31	.054W*	.044W*	.089W*		200	2.6	
BB300		42,500	70,000	3.75/.66	3.52:1	5.34	.044W*	.035W*	.117W*		360	3.2	
BB400		200,000	200,000	4.00/1.00	3:1	3.00	.078W*	.063W*	.117W*		740	4.8	
			Inverted Assembly Screw in Tension	Inverted Assembly Screw in Compression									
BB150		15,000	15,000	1.50/.25	2.69:1	10.77	.022W*	.018W*	.044W*	72.2%	52	0.7	
BB225		30,000	30,000	2.25/.50	2.15:1	4.31	.054W*	.044W*	.089W*		200	2.6	
BB300		70,000	42,500	3.75/.66	3.52:1	5.34	.044W*	.035W*	.117W*		360	3.2	
BB400	200,000	200,000	4.50/1.00	3:1	3.00	.078W*	.063W*	.117W*	740		4.8		

**Important Note:** Bevel Ball Actuators are not self-locking. Brake motors or external locking systems are required.

\*W: Load in Pounds.

**Pinion Torque (raising):** The torque required to continuously raise a given load.

**Pinion Torque (holding):** The torque required to hold a given static load in position.

**Screw Torque:** The torque required to resist screw rotation (translating design) and traveling nut rotation (KFTN design).

**Lead:** The distance traveled axially in one rotation of the lifting screw.

**Pitch:** The distance from a point on the screw thread to a corresponding point on the next thread, measured axially.

## Design Tips

- Determine the load to each actuator.
- Determine the orientation and type of load; for instance, from the chart above it may be an upright compression load or an inverted compression load.
- Jax® software can be used to determine the following:
  - The allowable static compression load for a given rise (or use Column Loading Chart on page 162)
  - The allowable dynamic load for a given rise
  - Ball nut life (or use Life Expectancy of the ball screw chart on page 163)
  - System horsepower and torque – also see item #4
- When a direct motor drive is used in a system, consideration must be given to the input starting torque requirements and the motor horsepower will need to be increased accordingly (JAX® software will not do this). Contact Joyce/Dayton for assistance.
- When selecting bevel ball actuators for an interconnected row or system (p. 195), careful attention must be given to the input and output shaft rotations. For example, if the input shaft rotation on the first actuator is clockwise, the output shaft(s) on that same actuator will rotate counter-clockwise. To insure all actuators raise and lower in unison, alternating actuators must be specified with right and left hand acme screw threads. For example, if you need five actuators interconnected in a straight line and the first actuator is right hand, the third and fifth actuator will also need to be ordered as right hand and the second and fourth actuator will need to be ordered as left hand. Bevel ball actuators are supplied standard with right hand ball screws. To order the left hand ball screw option, add an "L" to the end of your bevel ball actuator part number as shown on page 160.
- Bevel ball actuators are not self-locking. They will lower under load. A brake motor or other external locking system is required.
- Bevel ball actuators are furnished with one input shaft (pinion) in position #2. Actuators may be ordered with up to three input shafts located at any combination of positions # 1, 2, or 3.
- Translating bevel ball actuators are designed for grease lubrication. The upper bearing is grease lubricated through a fitting on top of the jack. Light oil must be applied directly to the lifting screw.
- Typically actuators are mounted upright with the jack base plate parallel to the horizon. If the base plate is oriented any other way, contact Joyce/Dayton for lubrication and other instructions.

# BEVEL BALL ACTUATORS COLUMN LOADING

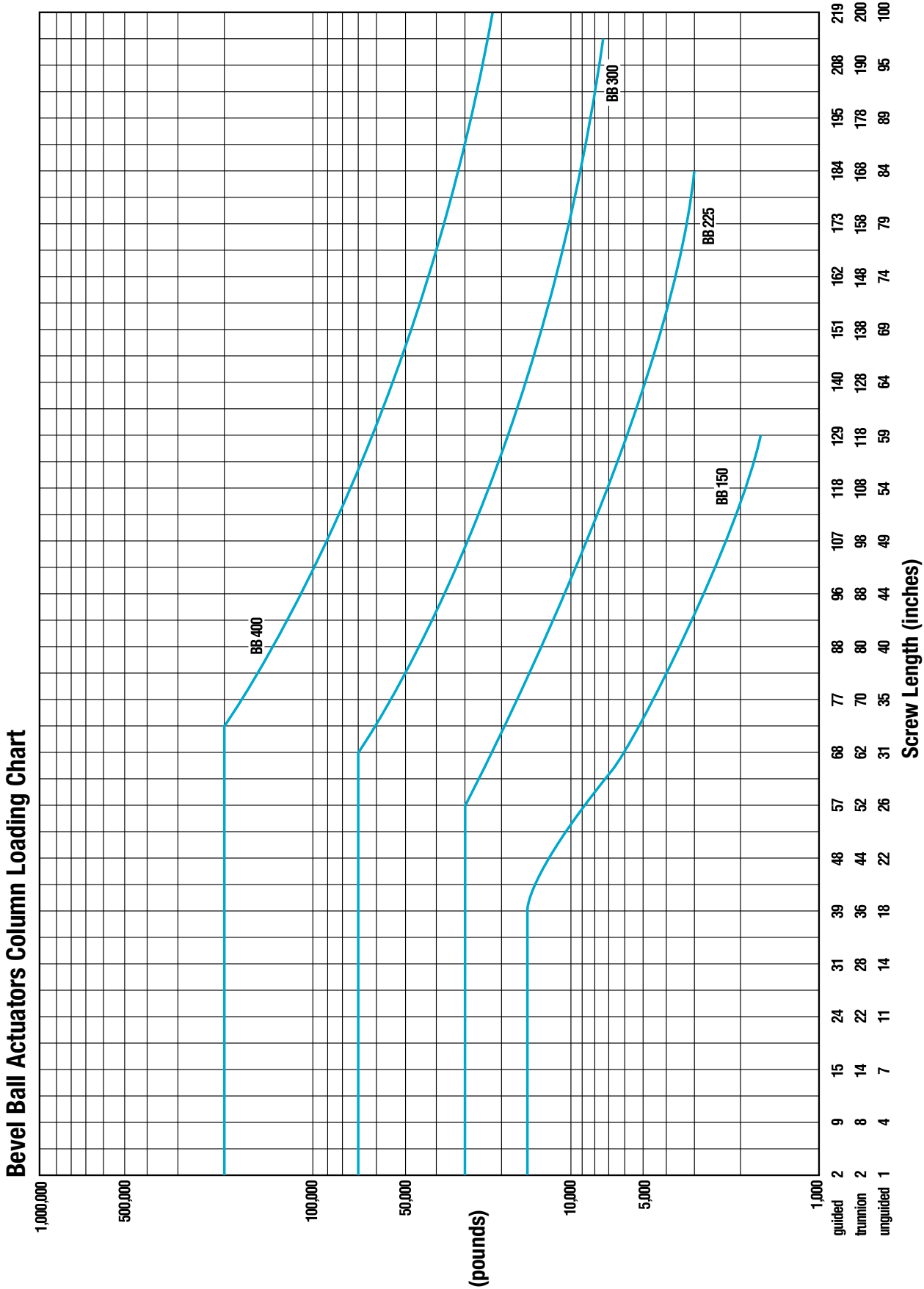

This chart includes a 2:1 Factor-of-Safety based on the Euler-Johnson equation for column loading (Oberg, Erik et al: Machinery's Handbook, 24th Edition. c. 1992 Industrial Press Inc.)  
 The horizontal portion of each line represents the jack's maximum static capacity.

# BEVEL BALL ACTUATORS LIFE EXPECTANCY

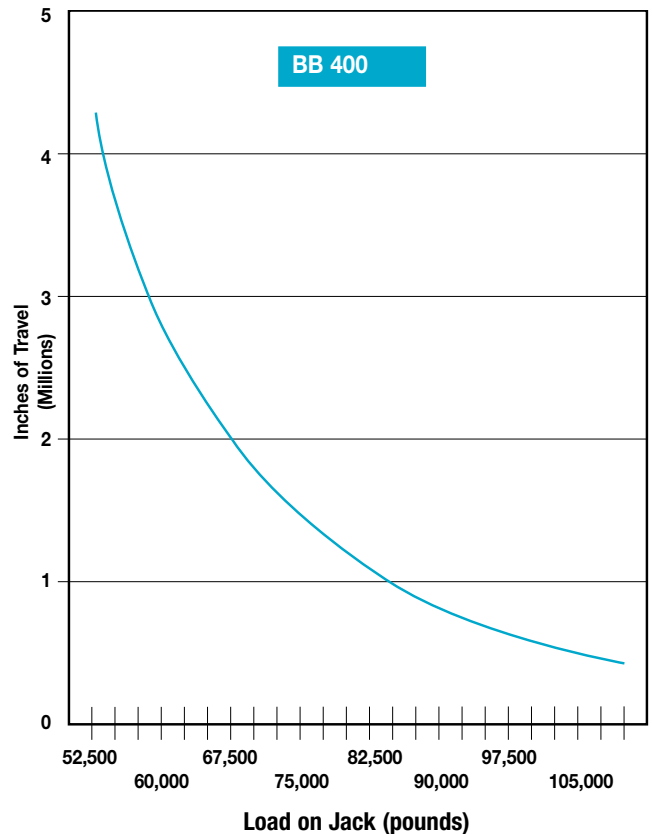
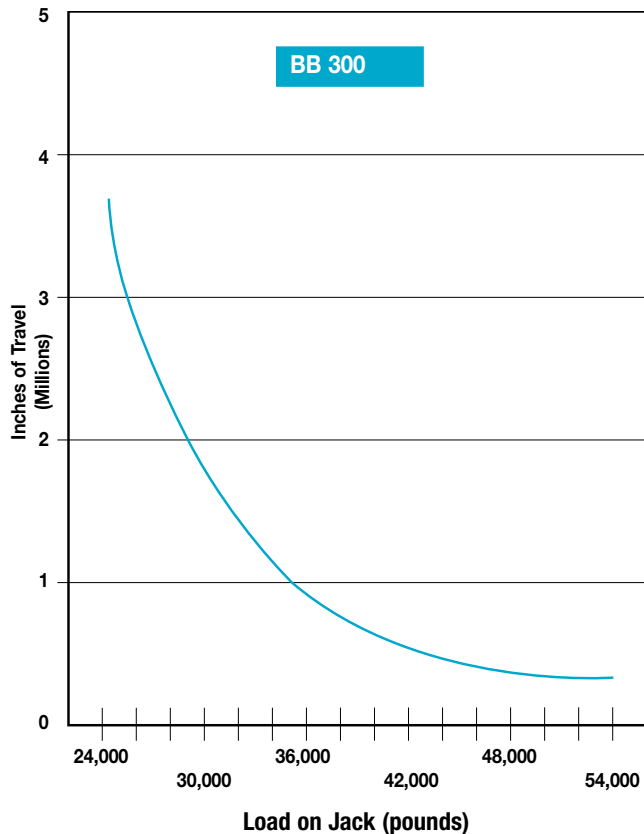
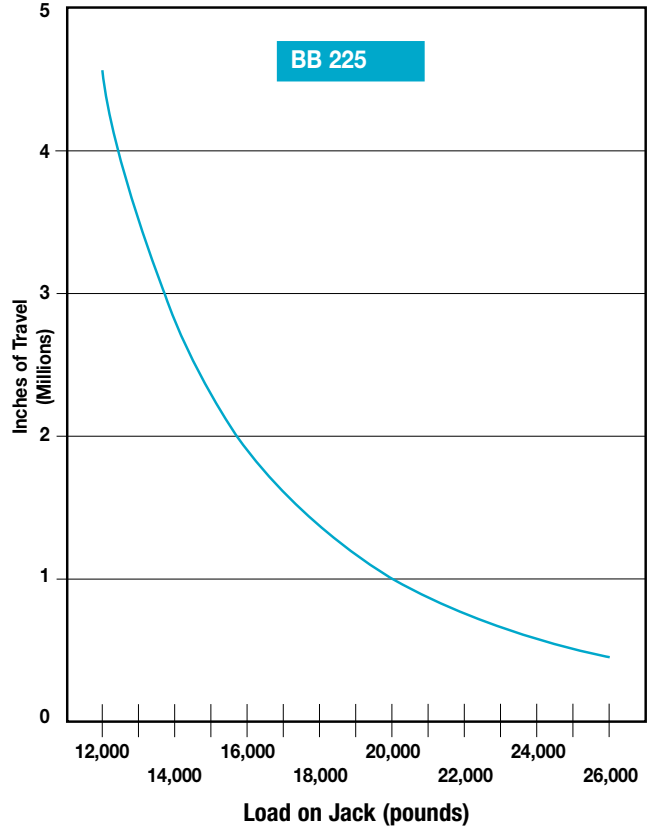
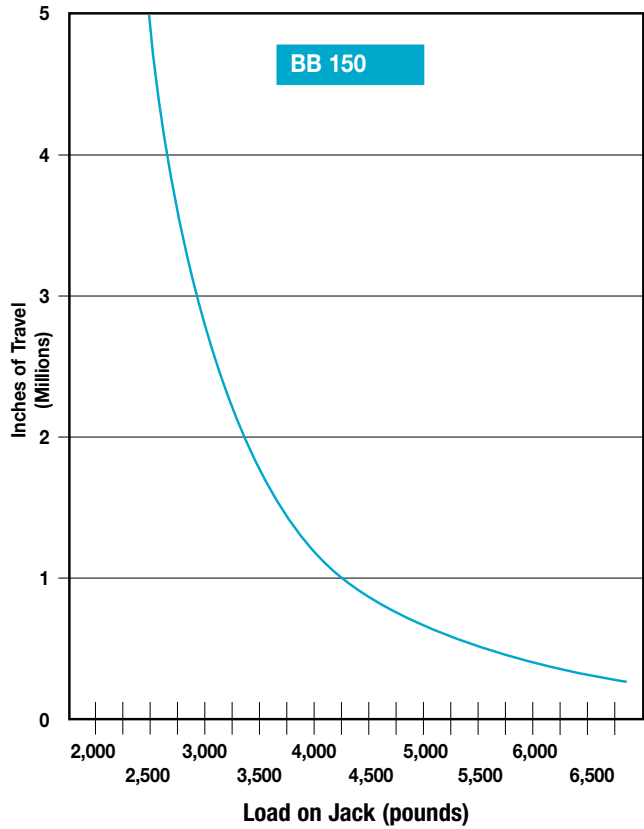

# BEVEL BALL ACTUATORS

## BB 150 - 1 1/2" SCREW

### Upright

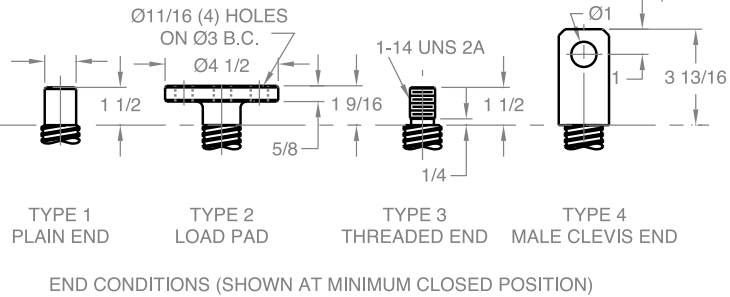
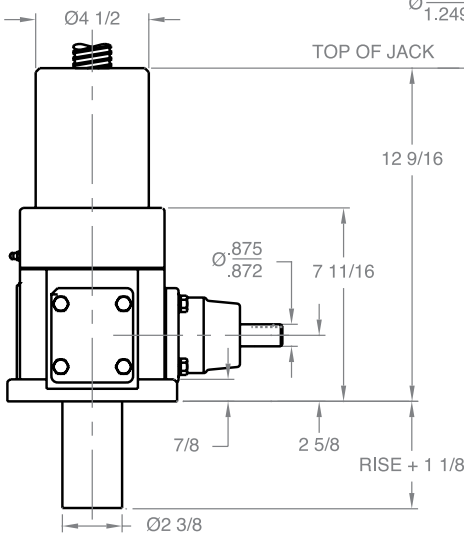

### Upright traveling nut

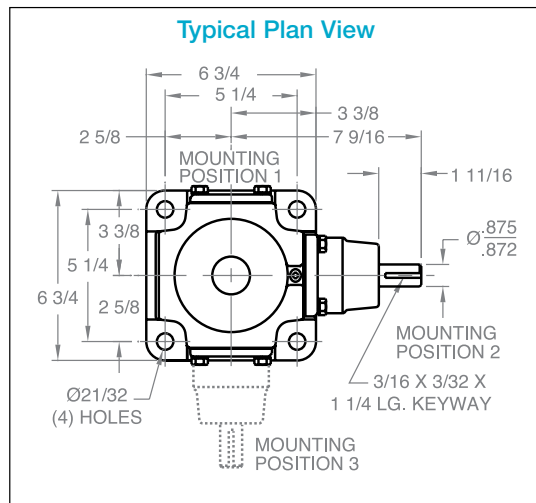
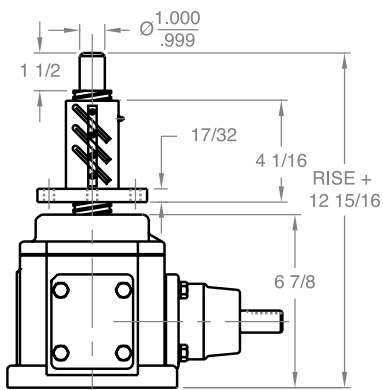

### Inverted traveling nut

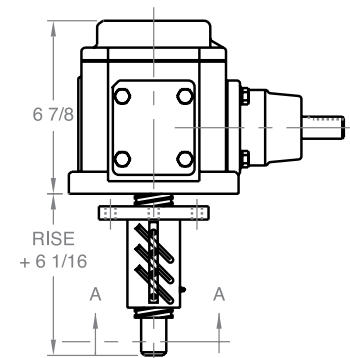

### Inverted

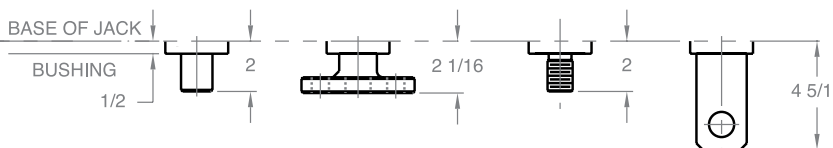
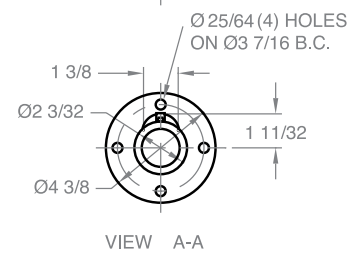
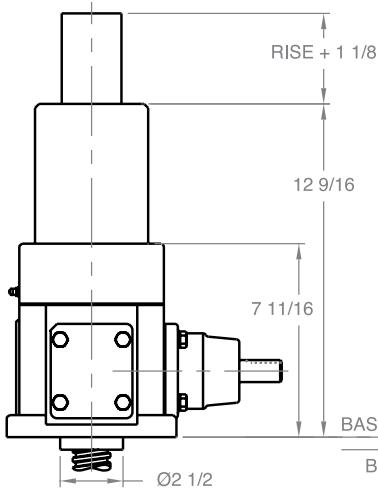

Note: Drawings are artist's conception — not for certification; dimensions are subject to change without notice.

# BEVEL BALL ACTUATORS

BB 225 - 2 1/4" SCREW

## Upright

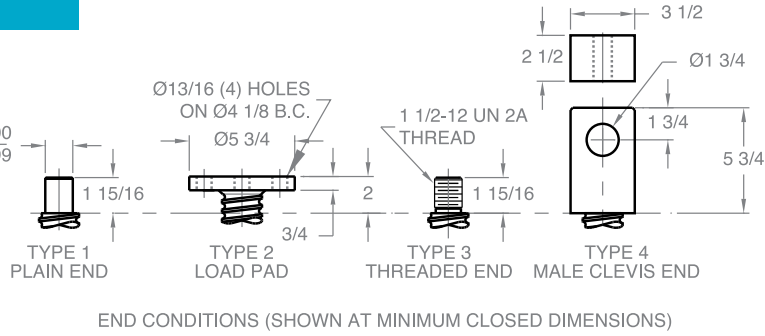
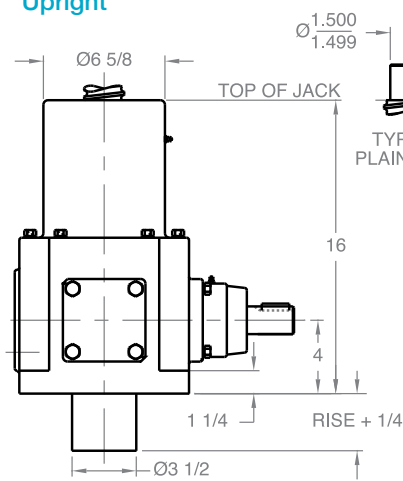

## Upright traveling nut

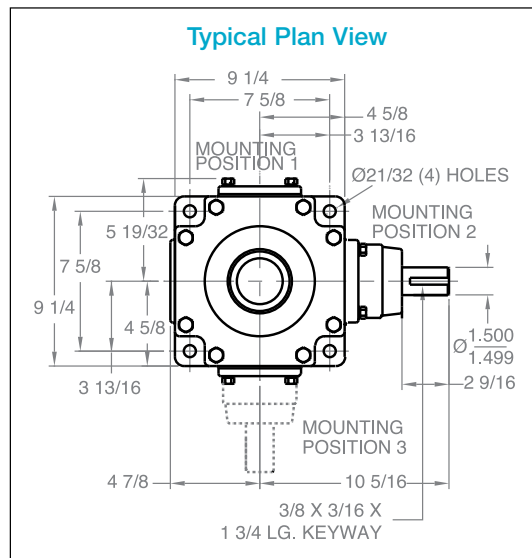
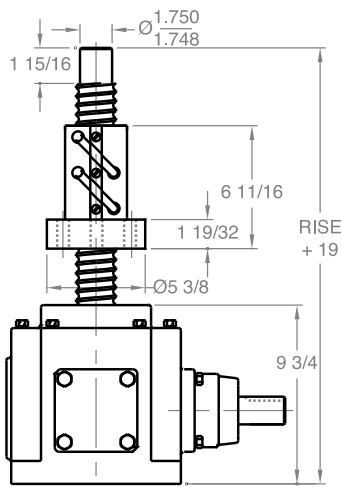

## Inverted traveling nut

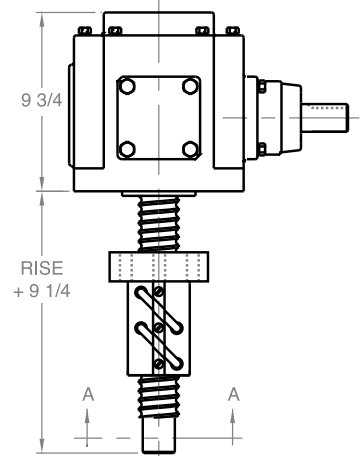

## Inverted

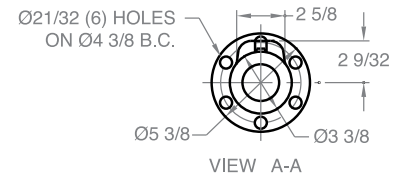
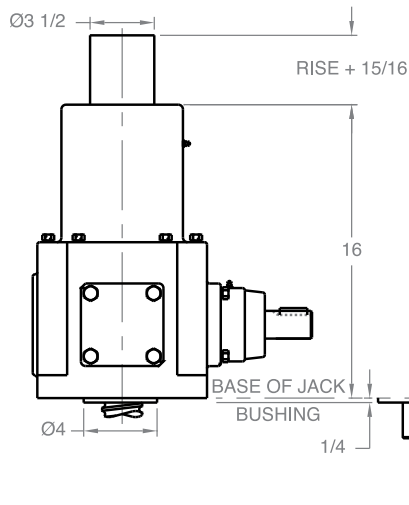

Note: Drawings are artist's conception — not for certification; dimensions are subject to change without notice.

# BEVEL BALL ACTUATORS

BB 300 - 3" SCREW

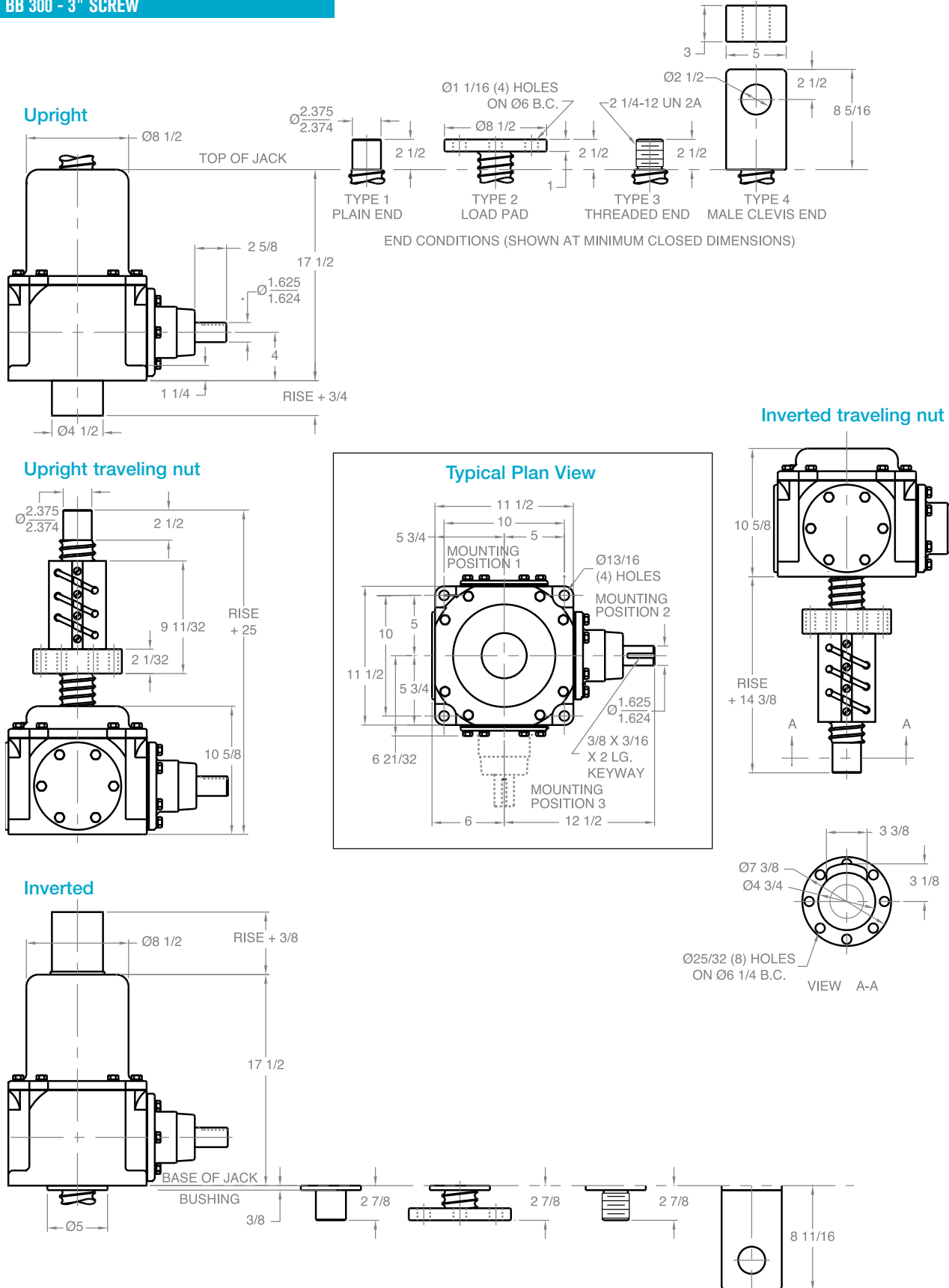

Note: Drawings are artist's conception — not for certification; dimensions are subject to change without notice.

# BEVEL BALL ACTUATORS

BB 400 - 4" SCREW

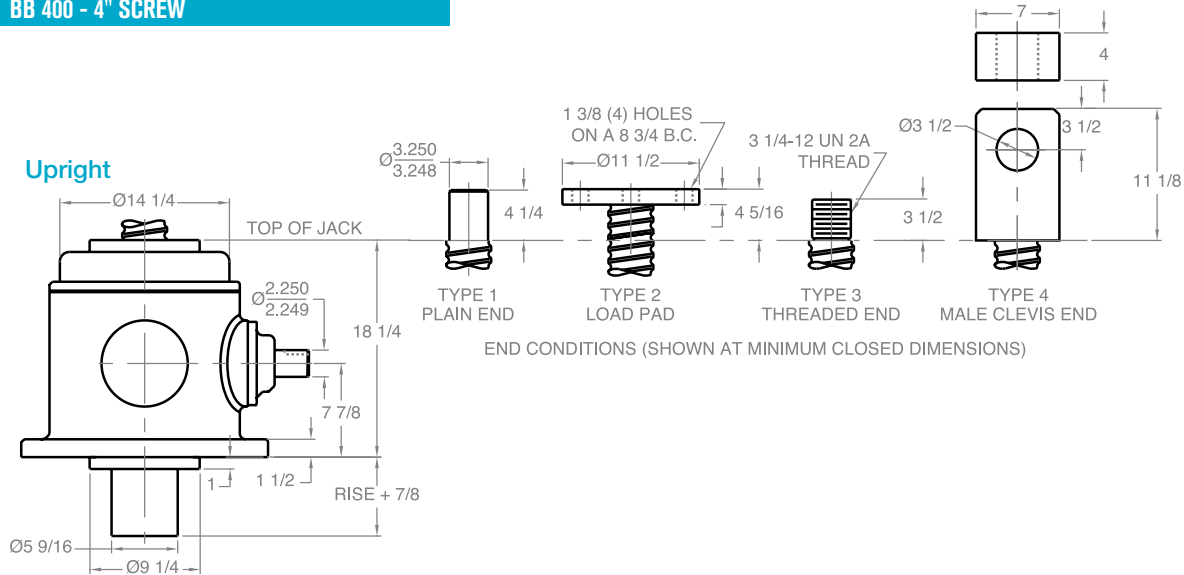

**Upright traveling nut**

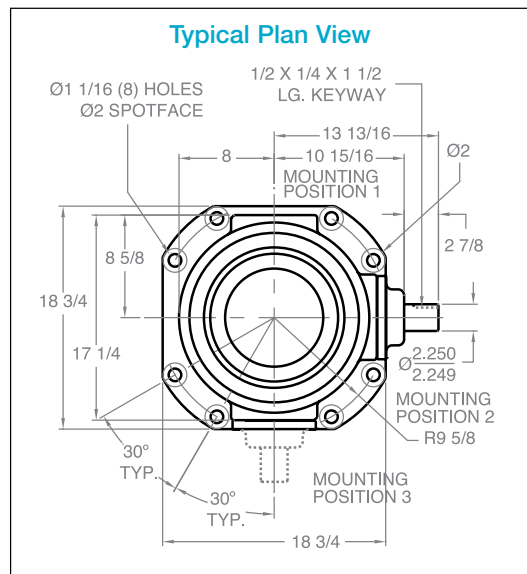
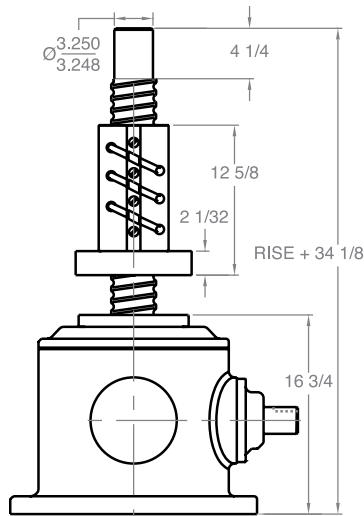

**Inverted traveling nut**

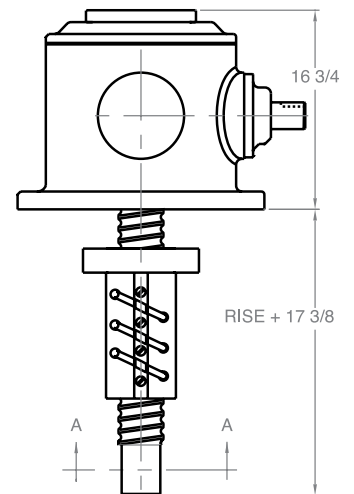

**Inverted**

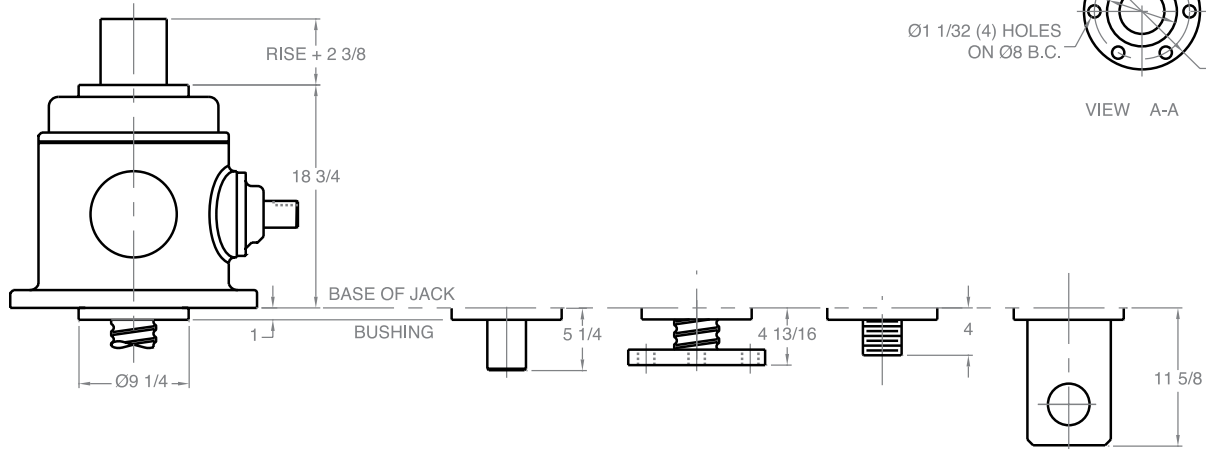

Note: Drawings are artist's conception — not for certification; dimensions are subject to change without notice.