

This 1 1/2"-2 double lead acme machine screw is available in both alloy steel and stainless steel with a corresponding aluminum bronze nut. Choose from right-hand or left-hand threads.

MACHINE SCREW SPECIFICATIONS	RH	LH
ALLOY STEEL SCREW PART NO.	AS 150 R 050 A	AS 150 L 050 A
STAINLESS STEEL SCREW PART NO.	AS 150 R 050 S	AS 150 L 050 S
THREAD FORM	ACME	
SCREW DIAMETER - TURNS / INCH	1 1/2" - 2	
PITCH / LEAD	0.250 IN./0.500 IN.	
ROOT DIAMETER	1.196 IN.	
SCREW WEIGHT (LB./FT.)	4.9	
TORQUE TO RAISE 1 POUND	0.171 IN.-LB.	
MAXIMUM SCREW LENGTH	20 FEET"	

* 12 feet for stainless steel stock

Nut and Flange Specifications

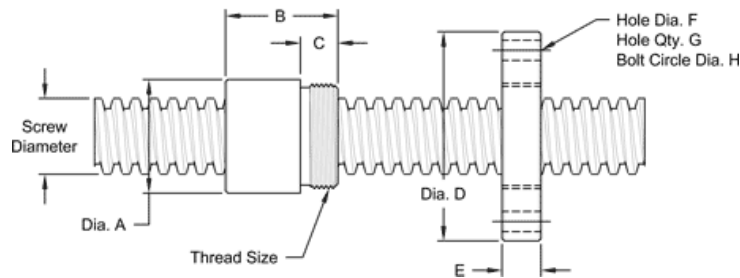

NUT SPECIFICATIONS	RH	LH
NUT PART NO.	AN 150 R 050 B	AN 150 L 050 B
NUT WITH FLANGE PART NO.	AF 150 R 050	AF 150 L 050
DYNAMIC LOAD CAPACITY (LBS.)	11,250	
STATIC LOAD CAPACITY (LBS.)	36,000	
EFFICIENCY	47.6%	
MATERIAL	BRONZE	
NOMINAL DIAMETER "A"	2.12 IN.	
NUT LENGTH "B"	2.30 IN.	
THREAD LENGTH "C"	0.812 IN.	
THREAD SIZE	1.967-18 UN	
FLANGE PART NO.	FL-1967	
FLANGE DIAMETER "D"	4.20 IN.	
FLANGE THICKNESS "E"	0.832 IN.	
FLANGE HOLE DIAMETER "F"	0.397 IN.	
NUMBER OF HOLES IN FLANGE "G"	4	
FLANGE BOLT CIRCLE "H"	3.440 IN.	
FLANGE MATERIAL	BLACK OXIDE COATED STEEL	