

This 2 1/4"-4 single lead acme machine screw is available in both alloy steel and stainless steel with a corresponding aluminum bronze nut. These are available with right-hand or left-hand threads.

| MACHINE SCREW SPECIFICATIONS | RH | LH |
|--------------------------------|----------------|----------------|
| ALLOY STEEL SCREW PART NO. | AS 225 R 025 A | AS 225 L 025 A |
| STAINLESS STEEL SCREW PART NO. | AS 225 R 025 S | AS 225 L 025 S |
| THREAD FORM | | ACME |
| SCREW DIAMETER - TURNS/INCH | | 2 1/4" - 4 |
| PITCH/LEAD | | 0.250 IN. |
| ROOT DIAMETER | | 1.944 IN. |
| SCREW WEIGHT (LB/FT) | | 11.2 |
| TORQUE TO RAISE 1 POUND | | 0.178 IN.-LB. |
| MAXIMUM SCREW LENGTH | | 20 FEET* |

* 12 feet for stainless steel stock

Nut and Flange Specifications

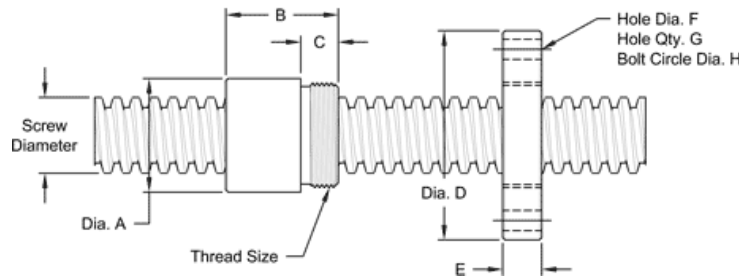

| NUT SPECIFICATIONS | RH | LH |
|-------------------------------|----------------|--------------------------|
| NUT PART NO. | AN 225 R 025 B | AN 225 L 025 B |
| NUT WITH FLANGE PART NO. | AF 225 R 025 | AF 225 L 025 |
| DYNAMIC LOAD CAPACITY (LBS) | | 30,000 |
| STATIC LOAD CAPACITY (LBS) | | 81,000 |
| EFFICIENCY | | 23.1% |
| MATERIAL | | BRONZE |
| NOMINAL DIAMETER "A" | | 3.38 IN. |
| NUT LENGTH "B" | | 3.06 IN. |
| THREAD LENGTH "C" | | 1.560 IN. |
| THREAD SIZE | | 3.137-12 UN |
| FLANGE PART NUMBER | FL-3137 | |
| FLANGE DIAMETER "D" | | 5.38 IN |
| FLANGE THICKNESS "E" | | 1.580 IN. |
| FLANGE HOLE DIAMETER "F" | | 0.656 IN. |
| NUMBER OF HOLES IN FLANGE "G" | | 6 |
| FLANGE BOLT CIRCLE "H" | | 4.375 IN. |
| FLANGE MATERIAL | | BLACK OXIDE COATED STEEL |