

**This 3 3/4"-1 1/2 single lead acme machine screw** is available in both alloy steel and stainless steel with a corresponding aluminum bronze nut. Choose right-hand or left-hand threads.

MACHINE SCREW SPECIFICATIONS	RH	LH
ALLOY STEEL SCREW PART NO.	AS 375 R 067 A	AS 375 L 067 A
STAINLESS STEEL SCREW PART NO.	AS 375 R 067 S	AS 375 L 067 S
THREAD FORM	ACME	
SCREW DIAMETER - TURNS/INCH	3 3/4" - 1 1/2	
PITCH/LEAD	0.667 IN.	
ROOT DIAMETER	3.009 IN.	
SCREW WEIGHT (LB./FT.)	38.3	
TORQUE TO RAISE 1 POUND	0.329 IN.-LB.	
MAXIMUM SCREW LENGTH	20 FEET*	

\*12 feet for stainless steel stock

### Nut and Flange Specifications

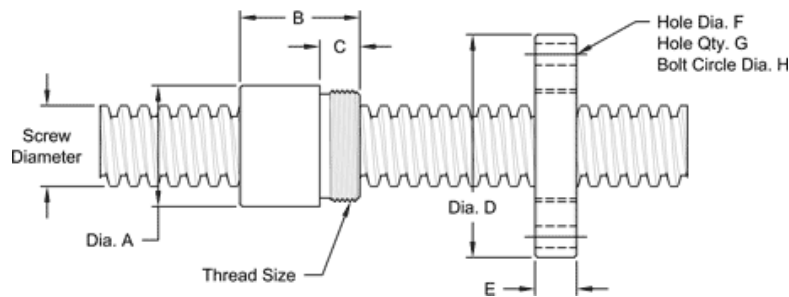

NUT SPECIFICATIONS	RH	LH
NUT PART NO.	AN 375 R 067 B	AN 375 L 067 B
NUT WITH FLANGE PART NO.	AF 375 R 067	AF 375 L 067
DYNAMIC LOAD CAPACITY (LBS.)	70,000	
STATIC LOAD CAPACITY (LBS.)	260,000	
EFFICIENCY	33.1%	
MATERIAL	BRONZE	
NOMINAL DIAMETER "A"	5.00 IN.	
NUT LENGTH "B"	5.50 IN.	
THREAD LENGTH "C"	2.000 IN.	
THREAD SIZE	4.750-12 UN	
FLANGE PART NUMBER	FL-4750	
FLANGE DIAMETER "D"	9.00 IN	
FLANGE THICKNESS "E"	2.020 IN.	
FLANGE HOLE DIAMETER "F"	1.063 IN.	
NUMBER OF HOLES IN FLANGE "G"	4	
FLANGE BOLT CIRCLE "H"	7.000 IN.	
FLANGE MATERIAL	BLACK OXIDE COATED STEEL	